

SINGLE RING STOOL ASSEMBLY INSTRUCTIONS

Parts List

- | | | |
|---------------------------------|--------------------------------|------------------------|
| 1 Open-end Wrench | 5 Nuts and bolts (8) | 9 Stool pad (1) |
| 2 Allen wrenches (2) | 6 Machine screws (4) | 10 Swivel plate (1) |
| 3 Shims (4) | 7 Stool legs (2) | 11 Multi-ring base (1) |
| 4 Sleeved Allen head screws (4) | 8 Foot rest / support ring (1) | |

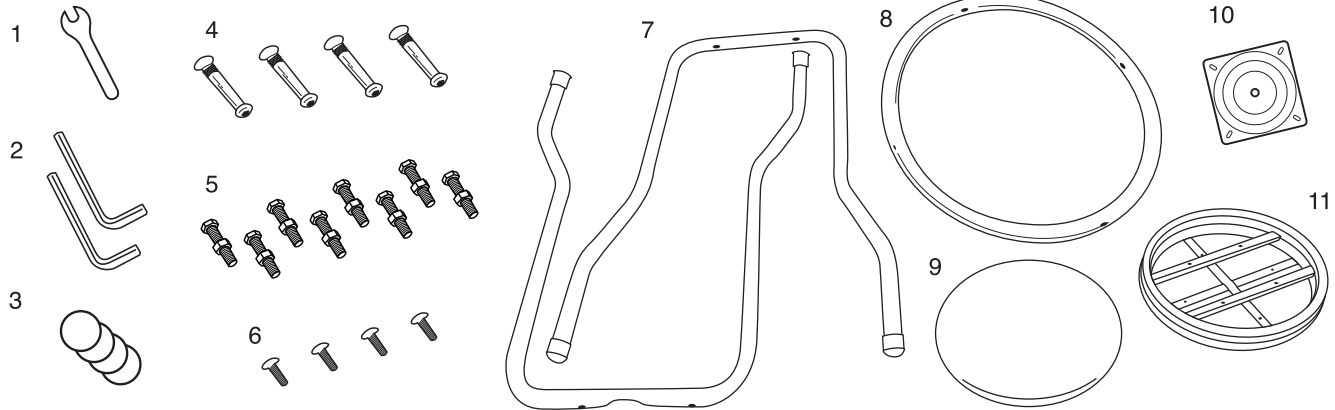

Step 1: Place the two legs together as shown in the image above.



Step 2: Slide the foot rest / support ring over the legs and align the holes on the ring with the holes on the legs. Slide the sleeved allen head screw into the hole and an allen head screw through the other side and tighten down using the supplied allen wrenches. Repeat for the other holes.



Step 3: Place the swivel plate on top of legs and align holes. Insert bolts and screw on nuts securely. Repeat for the other holes.



Step 4: Place the seat base on top of the swivel plate. Align the holes and insert the bolts. Screw on nuts securely. Repeat for the other holes.



Step 5: Turn the stool over and bolt the seat base to the pad as shown in the image above. Repeat for the other holes.



**image may be different depending on the style*

If the stool legs are uneven insert a shim (supplied) between the foot pad and the stool leg to level the stool.

